

# Neighbourhood Concept Plan

## Preliminary Plan

# South Creek



### Legend

- Existing Residential
- Future Residential
- Park/Open Space
- Atim Creek

Information provided is based on approved ASP at the time of printing and is subject to change.

**"Future Residential" includes Single Family and Duplex Style lots.**

For current planning information contact the Town of Stony Plain, Planning and Development Department.

December 2, 2024

WE CREATE WHAT WE BELIEVE IN

**QUALICO**<sup>®</sup>  
communities

[www.southcreek.ca](http://www.southcreek.ca)

# South Creek

PRELIMINARY PLAN

## Phase 4B&C Lot Information Plan

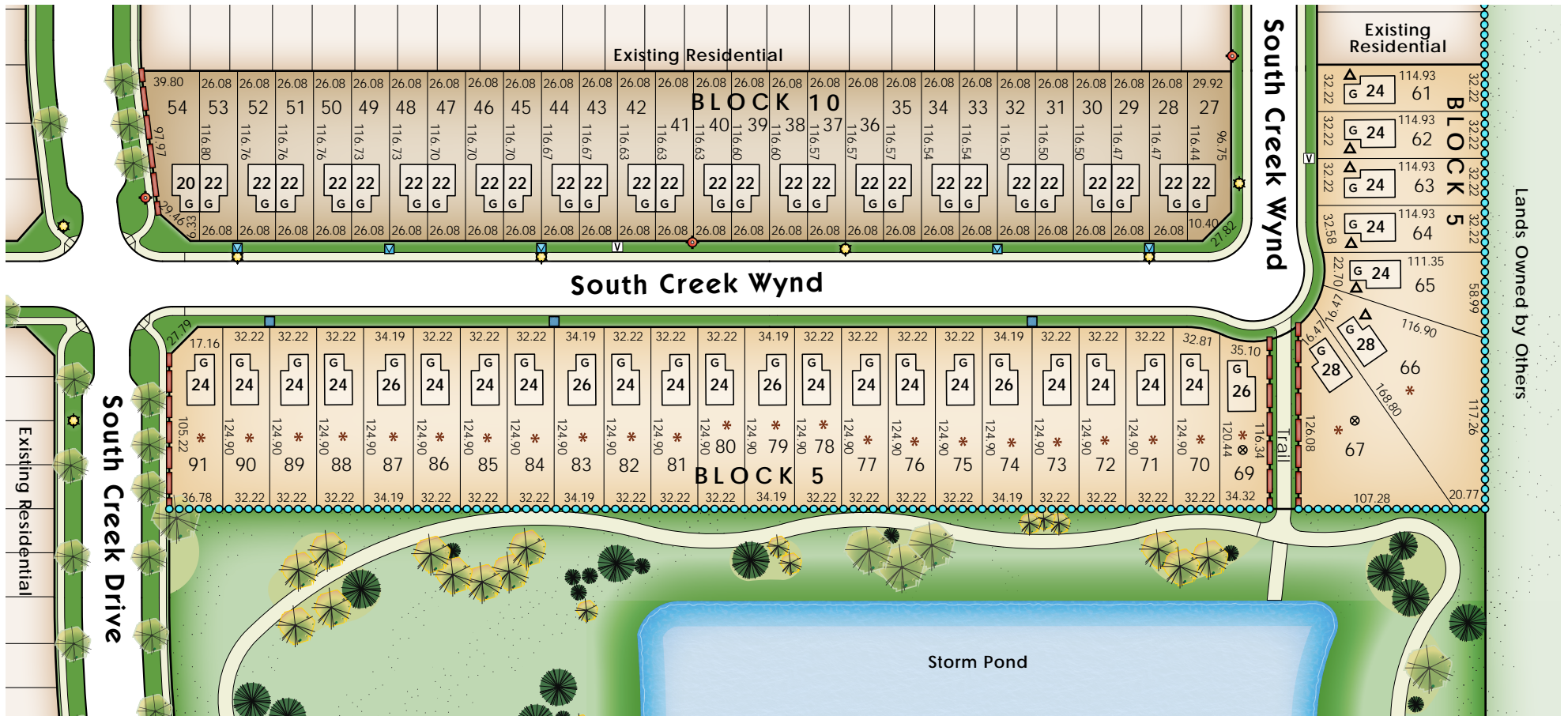

### LEGEND

- Street light
- Transformer
- Fire hydrant
- Service pedestal
- Utility vault
- Garage location with suggested house width in feet
- Screen fence
- Chain link fence
- Disturbed soil restrictive covenant
- Freeboard restrictive covenant
- Storm service requirement
- Single Family Home
- Duplex Style Home
- Approximate tree locations are subject to change

### NOTES:

1. All information shown on this plan is deemed accurate to the date shown. Landscape shown as conceptual only.
2. Location of street furniture and shallow utilities subject to change. Qualico will not relocate conflicts.
3. Bungalows and 2 storey require window wells.
4. Surveyors building pocket supersedes marketing map.
5. Retaining walls, if required, installed at purchaser's cost.
6. A 2.0 metre utility right of way is located in front all lots.
7. Roof leader connection to storm service required on lots 61 - 66, block 5.
8. Freeboard restrictive covenant on lots 66, 67 and 69 - 91, block 5 for lowest footing elevation of 704.483 m.

**PRELIMINARY PLAN.** This is prepared as a conceptual plan only and all elements are **subject to change** without notification and should not be relied upon. Please refer to the registered subdivision plan and approved engineering drawings to confirm all information. Dimensions are in feet and rounded.

2 DEC 2024

southcreek.ca

WE CREATE WHAT WE  
**BELIEVE IN**

**QUALICO**<sup>®</sup>  
communities